

SAFRA 2283





BUILDINGS' STRUCTURAL SPECIFICATIONS

ENVELOPE:

- External double hollow block wall envelope.
- Facades are plastered with mapexine and natural stone cladding.
- Balustrades shall be laminated structural glass with aluminum.
- Electrical rolling shutters in reception areas.
- External doors and windows: aluminum sliding double glazed clear tempered glass (Sidem or equivalent).

COMMON AREA FINISHING:

- Main Entrance: flooring in natural marble.
- False ceiling in painted gypsum board as per design.

ELEVATOR:

- One elevator per block 'High Lift' with UPS system.

STRUCTURE:

- Reinforced Concrete structure, foundations, retaining walls, columns, beams, slabs, and shear walls as per code zone II B for seismic design.

PARKING:

- Floor coating, strip painting, epoxy.
- Electrical parking gate with remote access control.

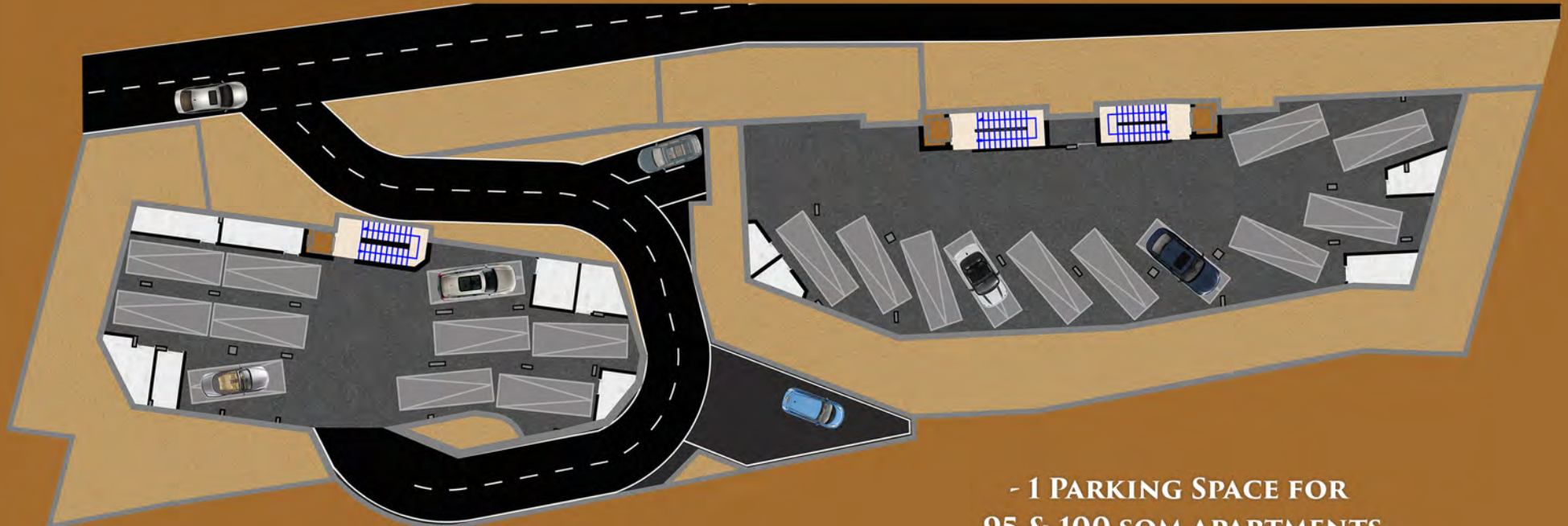

- 1 OR 2 PARKING SPACES
FOR 133 & 135 SQM APARTMENTS

- 1 OR 2 STORAGE ROOMS

- 1 PARKING SPACE FOR
95 & 100 SQM APARTMENTS

- 1 STORAGE ROOM



ELECTRICAL:

- Wires and cables: Cables du Liban or equivalent.
- European electrical wiring accessories: Legrand or equivalent.
- Electrical panel boards: Legrand or equivalent.
- Interphone system: Urmet italian brand
- TV System: Cable TV access is provided for reception and distributed in all the apartment.

APARTMENTS SPECIFICATIONS

ARCHITECTURAL:

- MAIN ENTRANCE, LIVING, DINING, BEDROOMS,
CORRIDOR & BALCONIES

Floor: Ceramic Tiles.

Walls: Plaster & Emulsion paint with three coats of putty.

- KITCHEN

Floor: Full body ceramic tiles.

Kitchen cabinets: Melamine Water Grade

Kitchen Counter Top: Granite.

- WOOD WORK

Entrance Doors: Cherry Wood.

Internal Doors: MDF painted.

MECHANICAL:

- Air-conditioning system: Drainage pipe installed.
- Hot Water: Central domestic hot water tank.
- Plumbing: PPR water pipes.
- Sewage Treatment Plan.

135 SQM
- BLOC A -



133 SQM
- BLOC A -





95 SQM
- BLOC C -



100 SQM
- BLOC C -





CONTACT

Twin Towers - 5th Floor
 Sarba Highway - Jounieh

Tel/Fax: 09 832 731

Mobile: 76 15 76 15
 03 49 49 24

 tahan.construction/safra2283

 /tahanconstruction



Developer & Contractor:



Engineering & Design Office:

